



SUNRISE

FOOD & BEVERAGE EQUIPMENT SOLUTIONS

Sunrise Engineers manufactures an extensive range of products designed & built to the highest standards of performance, quality and durability in the industry.

Our team develops advanced & innovative refrigeration technologies focused to generate long-term savings and value for our customers, that comes from a long, efficient product life.

PRODUCT RANGE

- ***GAS OPERATED EQUIPMENT***
- ***BULK COOKING EQUIPMENT***
- ***VENTILATION SYSTEMS***
- ***REFRIGERATED PREP TABLES***
- ***BLAST CHILLERS***
- ***BACK BAR RANGE***
- ***SINK TABLES AND FABRICATED ITEMS***

GAS EQUIPMENT - OPEN BURNER

Construction:

- External construction entirely with AISI 304.
- Top panel with 1.2 mm thickness. Orbital surface finishing; resistant toward scratches.
- Side panel with 1.2 mm deep-drawn surface.
- Front panel with 0.8 mm deep-drawn surface.
- Rubber leg with 40 mm height
- Connector between product on the back.

Features:

- Fully-welded basin for hygiene.
- Cast iron pot holder with long fin to support various size of pot or pan.
- External construction entirely with AISI 304.



Single Burner Gas Range

Item Code	Dimensions (inches)	Burners	PS Ring
VIE-103H	24 x 24 x 24	T35-70000BTU/HR	16 x 16
VIE-103HA	30 x 30 x 24	T35-70000BTU/HR	18 x 18

Two Burner Gas Range

Item Code	Dimensions (inches)	Burners	PS Ring
VIE-103H	48 x 24 x 24	T35-70000BTU/HR	16 x 16
VIE-103HA	30 x 30 x 24	T35-70000BTU/HR	18 x 18



Three Burner Gas Range

Item Code	Dimensions (inches)	Burners	PS Ring
VIE-109HA	72 x 30 x 34	T35/G11-70000 BTU/HR	18 x 18
VIE-109H	66 x 24 x 34	T35/G11-70000 BTU/HR	16 x 16



Table Top Single Burner



Item Code	Dimensions (inches)	Burners	PS Ring
VIE-706H	20 X 20 X 12	T-35-70000BTU/HR	12 X12
VIE-706HA	18 X 18 X 12	T-35-70000BTU/HR	12 X12

Four Burner with Oven

Item Code	Dimensions (inches)	Burners	POWER CONSUMPTION
VIE-131H	36x 36 x 36+6	G-9-70000 BTU/Hr	4 kW
VIE-131HA	42 x 36 x 36+6	G-9-70000 BTU/Hr	4 kW



Table Top Single Burner



Item Code	Dimensions (inches)	Burners	PS Ring
VIE-707H	20 X 20 X 15	G-11-70000BTU/HR	DIA 12
VIE-707HA	18 X 18 X 15	G-11-70000BTU/HR	DIA 12

Chinese Two Burner Range with Faucet

Item Code	Dimensions (inches)	Burners	PS Ring
VIE-105HA	72 x 30 x 34+18	T-35/T-22-70000BTU/HR	DIA 14/10
VIE-105H	66 x 27 x 34+18	T-35/T-22-70000BTU/HR	DIA 14/10



Product Features for Chinese Free Standing Ranges:

- Top and back splash of the range fabricated in heavy duty gauge of stainless steel.
- Gutter: 100mm throughout the length and provided with drain waste.
- Water Pipe for easy cleaning of the top surface is provided.
- Swivel cold water gooseneck faucet provided in the range.
- 03 no. of heavy duty removable Pan Support (with Exhaust Vent Cut Outs) for easy cleaning.

BULK COOKING



Tilting Brat Pan

Item Code	Dimensions (inches)	Burners	Capacity
VIE-704HA	36 x 30 x 42	M-IV-70,000 BTU/HR	80 ltrs
VIE-704HB	42 x 36 x 48	M-V-80,000 BTU/HR	120 ltrs.
VIE-704HC	48 x 36 x 48	M-V-80,000 BTU/HR	160 ltrs

Tilting Bulk Cooker

Item Code	Dimensions (inches)	Burners	Capacity
VE-701HA	36" x 30" x 42"	M-IV-70,000 BTU/HR	80 ltrs
VIE-701HB	42" x 36" x 48"	M-V-80,000 BTU/HR	120 ltrs.
VIE-701HC	48" x 36" x 48"	M-V-80,000 BTU/HR	160 ltrs



Product Features for Bulk Cooking Ranges:

- Fully constructed in heavy duty gauge of stainless steel.
- Double jacketed body insulated with high density glass wool.
- Heavy duty High Pressure Burner provided along with pilot Burner control.
- Tilting mechanism provided at right hand side of the unit.



Dhokla & Idli Steamer (Electric)

Item Code	Dimensions (inches)	Capacity	Power Consumption
VIE-124H	20" x 20" x 30"	54 ltrs.	2.0 KW
VIE-124HA	36" x 20" x 48"	108 ltrs.	4.0 KW
VIE-124HB	52" x 20" x 48"	162 ltrs.	6.0 KW

EXHAUST HOOD



TAPER TYPE HOOD
Low Proximity Hood



CONDENSATION HOOD

Used over equipment not producing grease laden vapors
Integral 4-sided perimeter gutter and one drain standard for high-moisture exhaust.



BOX TYPE HOOD

Advantages:

Construction: Single wall type hood fabricated of Type 304 stainless steel, when used in condensate applications. Type 430 stainless steel, when used for heat applications.

Capture and Containment: Rigid front has aerodynamic design that reduces radiant heat into kitchen, prevents condensation and provides exceptional capture and containment of cooking vapors.

Optional Accessories: Fresh Air Unit and Lights

REFRIGERATED COUNTERS



TECH SPECS

	AWR1350L2	AWR1350L2G	AWF1350L2
External Dimensions (WxDxH)	1350 x 700 x 850		1350 x 700 x 850
Net Volume (L)	300L		300L
Temperature Range (C)	-2 ~ +10	0 ~ +10	-10 ~ 0
Ambient Temperature (C)	43 (N)	32 (N)	43 (T)
Compressor Power (W)	339		520
Refrigerant	R134a		R404a
Cooling Type	Ventilated		Ventilated
Defrosting Type	Automatic		Automatic

	AWR1350L2	AWR1350L2G	AWF1350L2
External Dimensions (WxDxH)	1350 x 700 x 850		1350 x 700 x 850
Net Volume (L)	300L		300L
Temperature Range (C)	-2 ~ +10	0 ~ +10	-10 ~ 0
Ambient Temperature (C)	43 (N)	32 (N)	43 (T)
Compressor Power (W)	339		520
Refrigerant	R134a		R404a
Cooling Type	Ventilated		Ventilated
Defrosting Type	Automatic		Automatic



Monoblock Cooling System
Fast cooling and high efficiency, save space in cabinet, easy to maintain and clean



Thick Insulation
75 mm thickness of insulation for better heat preservation, reduced energy consumption



Air Guide Panel
Strong air flow is guided everywhere of the cabinet



Shelf & Guide
The height of shelves is adjustable as per the size of stored products



Round Edge & Corner
Food residue and water can be easily cleaned to reduce bacteria and guarantee the safety of food



Lock & Key
Unit provided with door locks



Digital Controller
Precisely control and display the temperature of food as per user requirement



Drawer Kits 1/2-200 & 1/3-150
Flexible and practical exchange of drawer kits and doors. Optional requirement



Strong Magnetic Gasket
Removable gasket for cleaning and replacement



Self-closing Door
Thicken door handle with end cover self close to reduce heat loss



Adjustable Bullet Feet
Range 130-200mm



Castor with brake
Optional

BLAST CHILLERS



COMPACT RANGE

TECH SPECS	BC5	BC6	BC10	BC20
External Dimensions (WxDxH)	740x700x837	800x860x906	800x860x1560	800x860x1945
Yield per Cycle (+90 +3 C)	18 Kgs	25 Kgs	50 Kgs	75 Kgs
Yield per Cycle (+90 -18 C)	10 Kgs	20 Kgs	30 Kgs	50 Kgs
No of Trays GN 1/1 H40	5	6	10	20
Energy Data	1.15 kW	1.7 kW	2.85 kW	4.6 kW
	230V 50Hz 1Ph		400V 50Hz 3Ph+N	



High Power Cooling System
High efficiency compressor



Extra-thick Insulation
75mm thickness of insulation for better heat preservation, reduced energy consumption



Food Core Probe
Precisely detects the core temperature of the products



Smart Controller
The pre-set cycles programs quickly ensures your products to be chilling or freezing

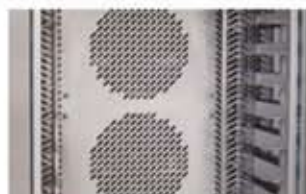

Strong Air Circulation
Big fan motor ensures quickly chilling and freezing to keep quality of foods inside



Strong Magnetic Gasket
Removable gasket for cleaning and replacement

POWER RANGE

TECH SPECS	BC40
External Dimensions (WxDxH)	1070x1650x2100
Yield per Cycle (+90 +3 C)	150 Kgs
Yield per Cycle (+90 -18 C)	100 Kgs
No of Trays GN 1/1 H40	40
Energy Data	96W
	400V 50Hz 3Ph+N



INDUSTRY RANGE

TECH SPECS	IBC1	IBC2	IBC3
External Dimensions (WxDxH)	1680x1565x2400	1680x2830x2455	1680x3980x2455
Yield per Cycle (+90 +3 C)	150 Kgs	260 Kgs	450 Kgs
Yield per Cycle (+90 -18 C)	100 Kgs	250 Kgs	400 Kgs
No of Trays GN 1/1 H40	1	2	3
Energy Data	19.5 kW	43 kW	55 kW
	400V 50Hz 3Ph+N		

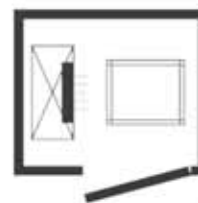

IBC1

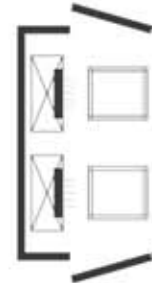

IBC2

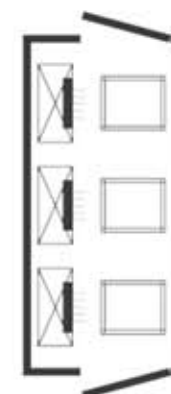

IBC3

MISCELLANEOUS ITEMS



Cocktail Station

Dimensions: 53 x 28 x 34 inches
Back-splash Height 4 inches

Key Accessories Included:

Separator Quantity 4
Garnish Size 4nos GN 1/9 x 100mm
Drawer for Garbage
Dripping Tray
Hygienic Speed Rail
Removable Speed Rail
Cutting Board
Jaguar Brand Mixer Faucet



Adjustable Wire Shelves

Sizes (3/4/5 Shelves):

48 x 18 x 74 inches
60 x 21 x 74 inches
60 x 24 x 74 inches

Finish Options:

Stainless Steel 304 Grade
MS Powder Coated



Stainless Steel Wall Shelves

Construction: 1.2 mm SS304 Grade

Sizes (Inches):

48 x 12
48 x 18
60 x 18
72 x 18



Wall Cabinet with Sliding Doors

Construction: 1.2 mm SS304 Grade

Sizes (Inches):

24 x 15 x 32
48 x 15 x 32
60 x 15 x 32
96 x 15 x 32

WORK TABLES AND SINK TABLES



Work Table

Construction:

1.2mm thickness top
1.0mm thickness shelves
0.8mm thickness doors and side coverings
SS304 Grade Matt Finish

Length Options (Inches): 30, 36, 48, 60, 72, 84, 98

Width Options (Inches): 20, 24, 30

Height Options (Inches): 32, 34, 36

Backsplash Options (Inches): None, 4, 6



Sink Table

Construction (SS304 Grade Matt Finish):

1.2mm thickness top
1.0mm thickness shelves
0.8mm thickness doors and side coverings

Length Options (Inches): 30, 36, 48, 60, 72, 84, 98

Width Options (Inches): 20, 24, 30

Height Options (Inches): 32, 34, 36

Backsplash Options (Inches): None, 4, 6

Sink Bowl Options (Inches): 12x12, 14x14, 16x16, 18x18

Single, Double, Triple



Handwash Sink
Knee Operated



Mop Sink